

# WAT-902H2 ULTIMATE 1/2" Multi-Function · High Sensitivity Camera

NIR visibility with full camera control



## Key features

- Min. illumination 0.0001 lx. F1.4 by NIR sensitive CCD sensor and our unique image signal amplifying circuit
- High quality image without noise under poor light condition
- Signal amplification level configurable up to 60dB and suitable for moving object in low light condition
- Electric iris, electric shutter, AGC, MGC, BLC and gamma
- Adjustable back focus CS mount
- Stability design housing for installation

## Dimensions

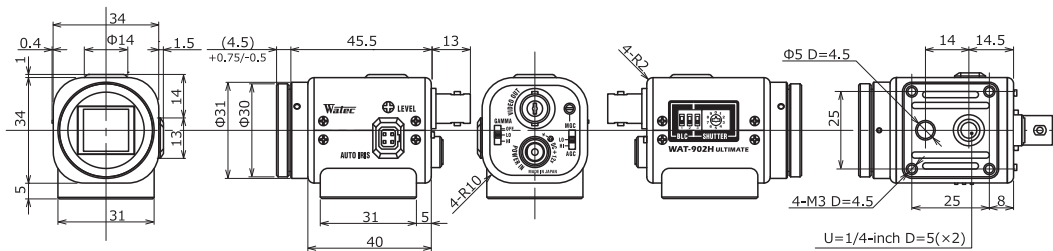

## Specifications

Video standard	CCIR	
Pick-up element	1/2 inch interline transfer CCD image sensor	
Number of effective pixels	752(H) × 582(V)	
Unit cell size	8.6μm(H) × 8.3μm(V)	
Synchronizing system	Internal	
Scanning system	2:1 interlace	
Video output	Composite video, 1.0 V(p-p) 75Ω (Unbalanced)	
Resolution (H)	More than 570TVL (Center)	
Minimum illumination	0,0001 lx F1.4 (AGC HIGH=60dB, Shutter=OFF)	
S/N	More than 50dB (AGC OFF=5dB, γ=1.0)	
Function settings	DIP Switch	
AE mode	Fixed	1/50, 1/120 sec.
	EI	1/250, 1/500, 1/1000, 1/2000, 1/5000, 1/10000, 1/100000 sec.
AGC	ON	5 - 32dB (LOW), 5 - 60dB (HIGH)
	OFF	—
MGC	5 - 60dB	
Gamma characteristics	γ≈0.35, 0.45, 1.0	
Video level	100IRE	
Noise reduction	—	
Wide dynamic range	—	
Lens iris	Video / DC (EIAJ, Auto-select)	
Back light compensation	BLC	
White blemish correction	—	
Sharpness	—	
Defog	—	
Digital zoom	—	
Privacy mask	—	
Mirror image	—	
Freeze	—	
Motion detection	—	
Neg.image	—	
Interface	BNC (Composite Video), Power in, Auto iris	
Power supply	DC+12V±10%	
Power consumption	1.32W (110mA)	
Operating temperature	-10 - +40°C	
Storage temperature	-30 - +70°C	
Operating / Storage humidity	95% RH or less (Without condensation)	
Lens mount	CS mount (Back focus adjustable)	
Weight	Approx. 98g	
Accessories	WPDC12 (DC plug), Hex. Wrench	

Options

C-mount lenses / Mount adaptors

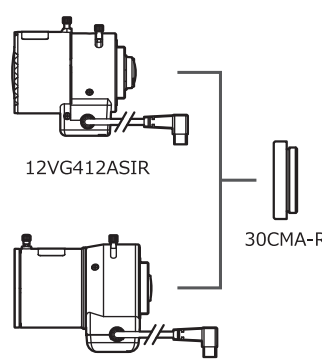

12VG412ASIR  
30CMA-R  
12VG1040ASIR

Miniature lenses / Mount adaptors



0814BC-12  
28MMA-M12-140

CS-mount lenses

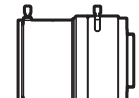

\*Not in our lineup

**WAT-902H2 ULTIMATE**

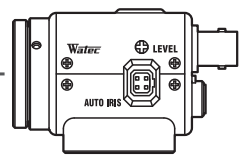

VIDEO OUT (BNC)

POWER IN (DC+12V)

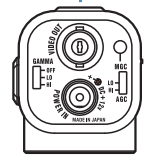

Cables

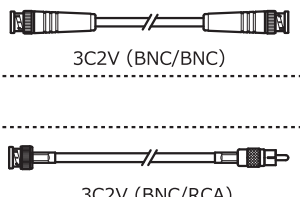

3C2V (BNC/BNC)  
3C2V (BNC/RCA)

BNC  
RCA



\*Not in our lineup

Power supply adaptors



SWI12-12-N-P5  
SWI12-12-E-P5

Stands



MS50  
WH-31  
WH-11  
WH-21

Water resistant camera housing / Mounting brackets

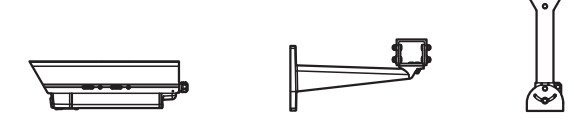

VCHO-15S  
WH-6N  
PTP-300